

PAPER 2 - LISTENING

PAPER 2 LISTENING

PART 1 Questions 1-7

There are seven questions in this part. For each question there are three pictures and a short recording. Choose the correct picture and put a tick (✓) in the box below it.

Example: Where did the woman leave her hat?

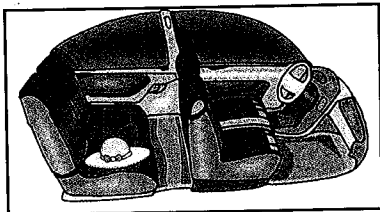

A ☐



B ☒



C ☐

1. What will they have for dinner?

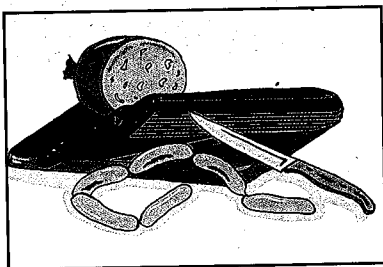

A ☐

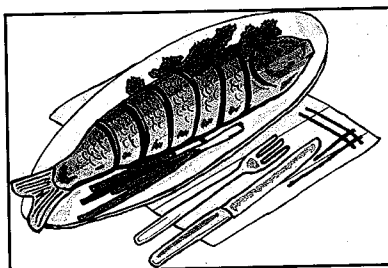

B ☐

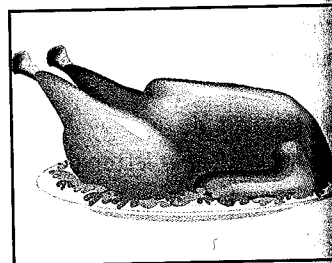

C ☒

2. What's the time?

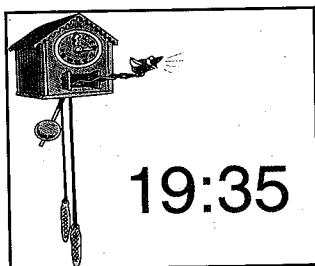

A ☒

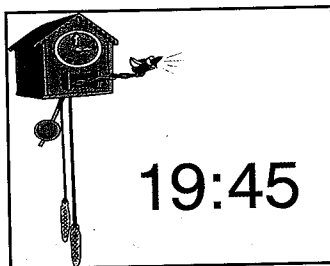

B ☐

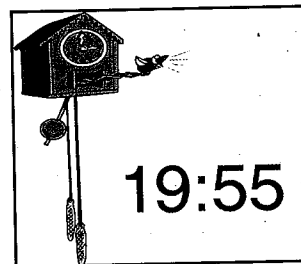

C ☐

3. Which dress does Jenny buy?



A ☐



B ☐



C ☒

4. Where will the man go first after work?

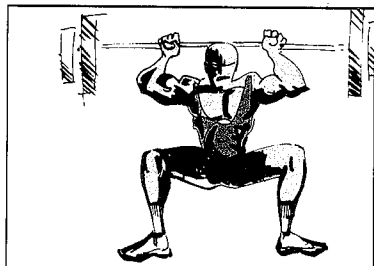

A ☐



B ☒

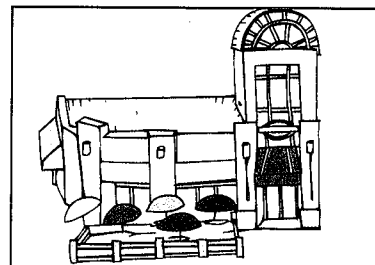

C ☐

5. How did the woman break her arm?

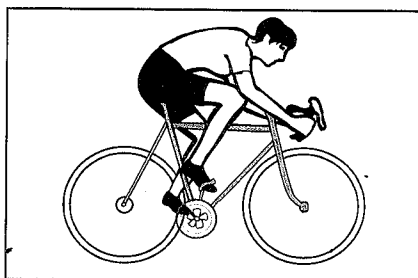

A ☐

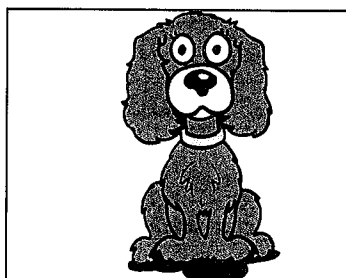

B ☒

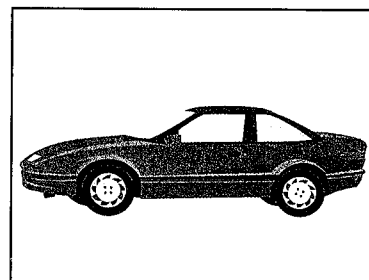

C ☐

6. Where is the remote control?

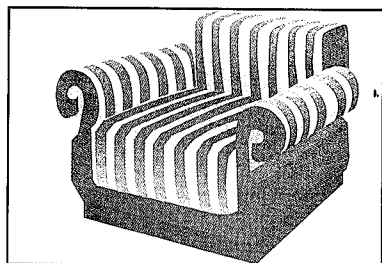

A ☐

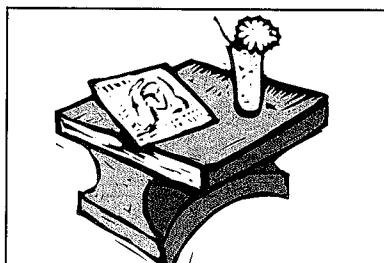

B ☐

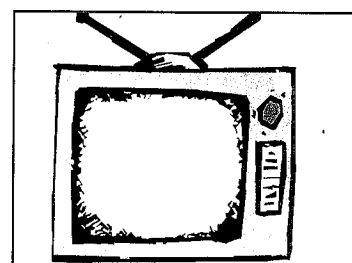

C ☒

7. Where did they stay on holiday this year?

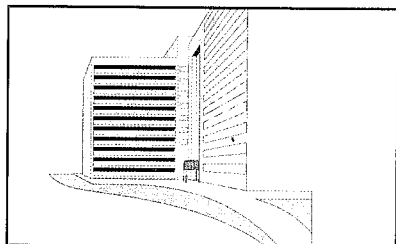

A ☒

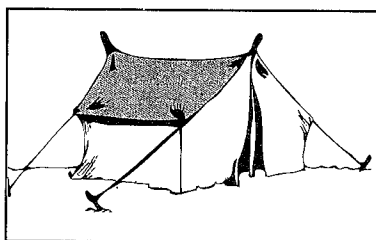

B ☐

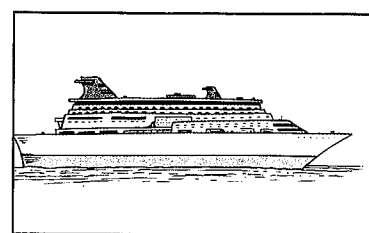

C ☐

PAPER 2 - LISTENING

PART 2 Questions 8-13

You will hear an interview with a woman who suffers from panic attacks, where she suddenly gets frightened for no reason. For each question, put a tick (✓) in the correct box.

8. What caused Margaret's first panic attack?

- A. She was overstressed at work.
- B. She was very tired.
- C. Nobody knows.

A	<input type="checkbox"/>
B	<input type="checkbox"/>
C	<input checked="" type="checkbox"/>

9. What does Margaret say about panic attacks?

- A. They are worse than a heart attack.
- B. They are as frightening as a heart attack.
- C. You usually only ever have one in your life.

A	<input type="checkbox"/>
B	<input checked="" type="checkbox"/>
C	<input type="checkbox"/>

10. How did Margaret feel about her first panic attack?

- A. angry
- B. shocked
- C. frustrated

A	<input type="checkbox"/>
B	<input checked="" type="checkbox"/>
C	<input type="checkbox"/>

11. Why did Margaret's husband buy her a camera?

- A. to keep her mind off her fear
- B. to give her a new career
- C. because she'd always wanted one

A	<input checked="" type="checkbox"/>
B	<input type="checkbox"/>
C	<input type="checkbox"/>

12. Why did Margaret forget where she was at the lake?

- A. She had a panic attack.
- B. She became confused.
- C. She was concentrating on the bird.

A	<input type="checkbox"/>
B	<input type="checkbox"/>
C	<input checked="" type="checkbox"/>

13. Why is it important that Margaret leaves her camera at home soon?

- A. It will show that she is better.
- B. She has become addicted to photography.
- C. Her husband thinks she is being unsociable.

A	<input checked="" type="checkbox"/>
B	<input type="checkbox"/>
C	<input type="checkbox"/>

PART 3 Questions 14-19

You will hear a radio announcement about a competition. For each question, fill in the missing information in the numbered space.

Win a 'dream night' at the theatre

There are (14) four pairs of tickets to be won.

Performance times:

Mid week 7.30 p.m.

Tuesday-Thursday afternoons (15) 2.30 p.m.

Saturday afternoons 2 p.m.

Ticket prices: From £11 - (16) £24.50

Tickets for children available at (17) half price

To book:

Telephone or book (18) online

Competition (19) closes / finishes June 13th.

PART 4 Questions 20-25

Look at the six sentences for this part. You will hear a conversation between a girl, Alison, and a boy, Bob, about pets. Decide if each sentence is correct or incorrect. If it is correct, put a tick (✓) in the box under A for YES. If it is not correct, put a tick (✓) in the box under B for NO.

20. Bob thinks a dog would be good company for Alison's grandma.
21. Bob doesn't like dogs.
22. Bob has found homes for the kittens.
23. Alison would be happy to work at the dogs' home without getting paid.
24. Bob thinks Alison is mad.
25. Bob and Alison will go to the dogs' home together.

A	B
YES	NO

✓	
---	--

	✓
--	---

	✓
--	---

✓	
---	--

	✓
--	---

	✓
--	---